

RAM PROMASTER

CURTAIN RAIL

What's Included:

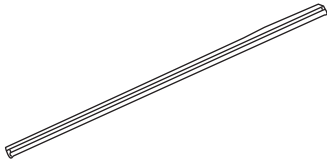

Curtain Rail and Mounting Rail

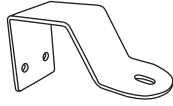

3x Mounting Brackets

You Will Need:



10mm Spanner or Socket

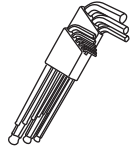

Hex Key Set

1. Use a hex key to remove the M6 15mm bolt from either end of the curtain rail. This allows needed access to the mounting rail.

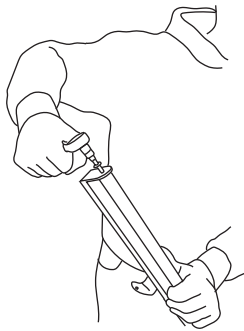

2. Install the largest mounting bracket to the middle of the mounting rail, using the included M6 25mm bolts. Apply with a washer and tighten with a locking nut. Repeat with the smaller mounting brackets on the outer ends of the mounting rail.

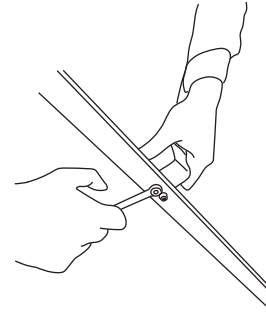

3. Locate the factory nylon nuts on the top of your headliner shelf and remove with a 10mm Spanner or socket.

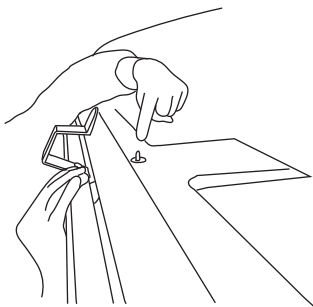

4. Hang the mounting bracket over the headliner shelf, aligning the mounting holes in each.

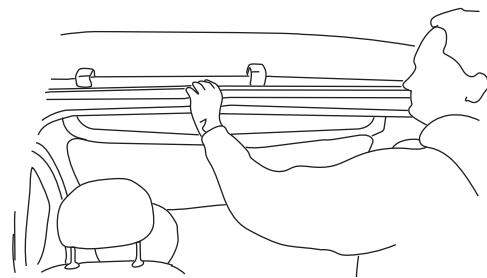

5. Once seated flat, secure the mounting brackets to the headliner shelf using existing bolts and new nylon nut provided. Note that these will cut a new thread into the nut.

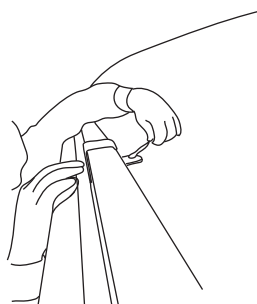

6. Finally, reinstall the curtain rail onto the mounting rail using M6 15mm bolts.

