

# FORD TRANSIT

## REAR DOOR WINDOW COVERS

### What's Included:



Left Rear Door Window Cover



Right Rear Door Window Cover



Alcohol Wipe



Metal Tabs + 3M Adhesive Tabs

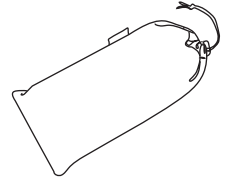

Storage Sack

Estimated Install Time: up to 30 Minutes

1. Use the included alcohol wipe to remove any dust or debris around the edge of the window glass.

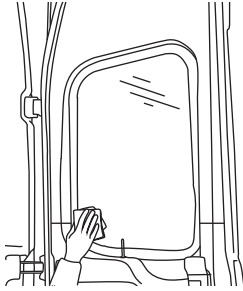

2. Remove the backing from one side of the 3M adhesive tab and attach to a metal tab. Repeat for all metal tabs supplied. **CAUTION:** Try to avoid touching the adhesive as it might reduce adhesion longevity.

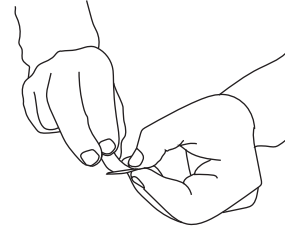

3. Looking at the back of your van with the rear doors open, start on the right side. Orient the window cover so that the black fabric faces outside, and the logo is facing you. Hold your window cover up to the window frame to identify where to place the metal tabs on the glass. The metal tabs need to match up with the magnets sewn inside the window cover edge on the window glass.

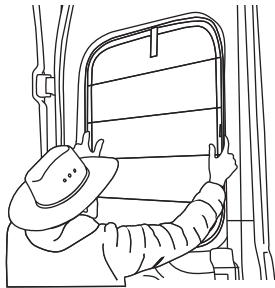

4. Peel the backing from the other side of the 3M adhesive tabs and stick to the window glass (**NOT** the plastic trim) where they align with the magnets. Repeat for all magnet locations.

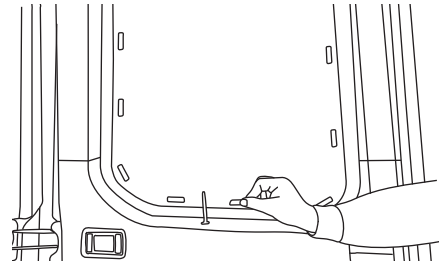

5. Attach the window cover to the metal tabs on the glass for a secure fit. Your window cover might be a little stiff at first but will soften over time.

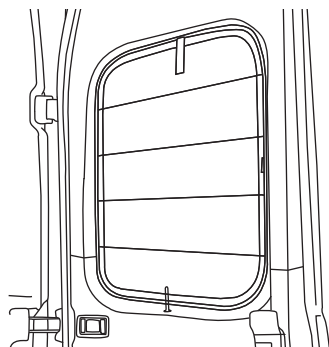

6. Repeat the process for the other van door. Step back and admire your work.

