

MERCEDES-BENZ SPRINTER

REAR DOOR UPPER STORAGE PANELS



CAUTION

Please read all steps before you begin. Installation of this product requires drilling through the first layer of sheet metal on the inside of your van doors. Take caution not to drill farther than about 3/8" or you risk drilling through the outside of the door. VanEssential is not responsible for any mistakes made.

What's Included:

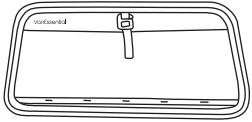

1X LEFT Rear Door Storage Panel

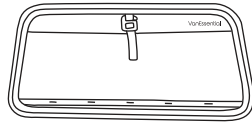

1X RIGHT Rear Door Storage Panel



T25 Screwdriver Bit



Sheet Metal Screws

You Will Need:

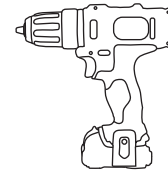

Power Drill



3/32" Steel Drill Bit with depth stop at 3/8"

1. If applicable, remove all plastic stock trim so that your door has the metal frame exposed.

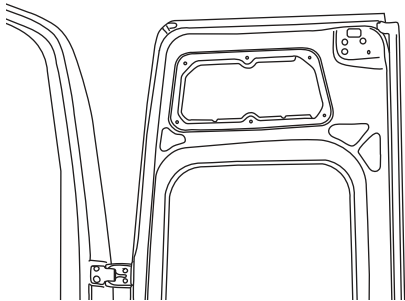

2. Hold up and align the panel to the upper frame indentation.

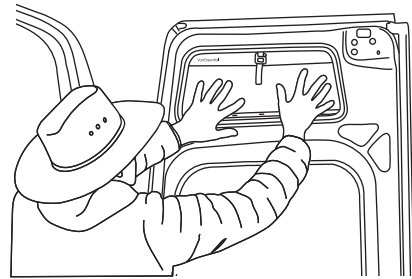

3. Starting in the upper left-hand corner, identify a spot between the two outer seams and carefully pre-drill a hole through the panel and into the van door.

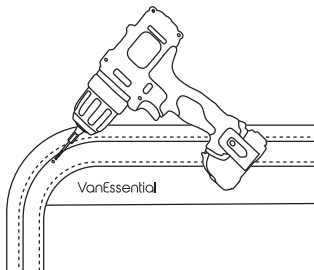

4. Drive a screw into the hole, securing the panel in place.

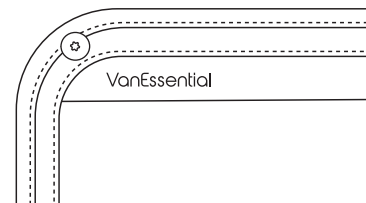

5. Repeat this process in each corner, and then add additional screws around the panel edge between the outer seams as needed for a secure fit.

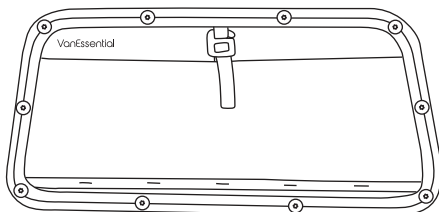

6. Repeat steps 1-5 for the second panel on the opposite door. You will likely have leftover screws. Step back and admire your work!

